



**FOREST**

ECONOMIC PARTNERSHIP

Delivering a thriving economy

# Forest Economic Partnership Stakeholder Meeting

18 September 2020

# Agenda

- 1. FEP Update**
- 2. Project Update**
- 3. Hartpury College and University**
- 4. Forest of Dean Recovery**
  - Forest of Dean Recovery Action Group Update
  - Forest of Dean District Council Start Up Grants
  - Growth Hub Update
  - FSB Membership Offer
- 5. Electing a New Stakeholder Chair**
- 6. AOB**



**FOREST**  
ECONOMIC PARTNERSHIP

Delivering a thriving economy

CIC Number: 12262533

# Forest Economic Partnership & CIC Update

(Wendy Jackson)

**210 Members**

**6 CIC Directors**

**3 Sub-Groups**

**7 Active Projects**



Interested in becoming a Stakeholder  
Director?

Please email [fep@fdean.gov.uk](mailto:fep@fdean.gov.uk) for more  
information.



**FOREST**  
ECONOMIC PARTNERSHIP

Delivering a thriving economy

CIC Number: 12262533

# Project Updates

(Andrew Callard)

# Current Active Projects

- Inspiring Forest - Postponed due to Covid-19
- Mobility as a Service - Seeking Funding
- Biosphere Reserve - Seeking Funding
- Tech Nation's - Ongoing watching brief
- Smart Rural - Ongoing watching brief
- Transport Study - Working Group
- How Fast; How Good? - Working at phase 2 of work programme



**FOREST**  
ECONOMIC PARTNERSHIP

Delivering a thriving economy

CIC Number: 12262533

# Hartpury College & University

(Stuart Emmerson)



# An Introduction to Hartpury: Background and opportunities

A LEVELS, DIPLOMAS, UNDERGRADUATE, POSTGRADUATE, RESEARCH

ANIMAL | AGRICULTURE | EQUINE | SPORT | VETERINARY NURSING



WELCOME TO HARTPURY





# Mission Statement

Hartpury will be a specialist niche provider delivering relevant, effective and high quality education and training for employment in land-based, sports and allied industries; locally, regionally, nationally and internationally.

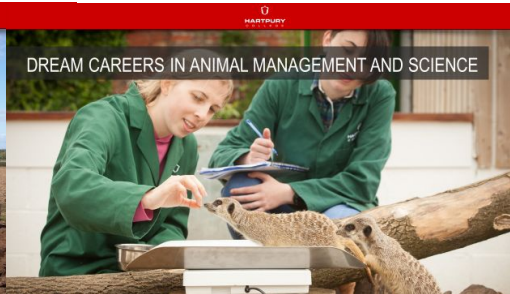

# OUR STRUCTURE





**Ofsted**  
Outstanding Provider

Rated Ofsted Outstanding in all areas

**70**  
Hartpury College celebrates **70th anniversary** in 2018

Only university in Gloucestershire to currently hold a Gold award from the Teaching Excellence Framework

**97%**  
of our university graduates are in employment or further study within six months\*

**TEF Gold**

\*DfE 2015-16 average over three years

Hartpury awarded university status in 2018

Our students come from nearly 50 different countries

Highest student satisfaction rating of all UK land-based colleges\*

**50m**  
Invested more than £50 million in our facilities in recent years, including our new £8.8 million Sports Academy

\*OfS 2017/18

★★★★★

As Hartpury University and Hartpury College, two outstanding specialist organisations side-by-side on one campus, with a shared mission and set of values, we will be well-positioned to meet national priorities including those raised within the government's Industrial Strategy. Hartpury's organisational structure strengthens our position as a leader in the delivery of high quality applied education and research.

**Russell Marchant, Vice-Chancellor, Principal and CEO**



# SOCIAL IMPACT

## Economic value of Hartpury

**Our total impact on the regional economy was £94.9 million in the 2016/17 financial year, which was equal to approximately 0.8% of Gross Valued Added (GVA) of the GFirst LEP area, equivalent to supporting 4,043 jobs.**

We're one of the largest employers in the area, with a total payroll of £16.8 million in 2016/17, much of which was ploughed back into the local economy by Hartpury staff.

Hartpury College graduates may earn £410,000 more during their working lives, and Hartpury University graduates £958,000 more, than someone with a less than entry level education working in the UK.

## Strong industry links

We're proud to work with more than 2,000 businesses in the UK and abroad, helping our students find the right work placements to best suit their future careers and ensuring our courses are developed to meet the needs of evolving industry demands.



## Constantly developing campus - £50million invested since 1994

- Lecture theatre complex
- Accommodation blocks
- Sports Academy
- Animal Science Centre
- Equine Therapy Centre
- Dairy Unit
- College Learning Centre
- Malcolm Wharton Centre at Home Farm
- Additional agricultural resource at Okle Clifford
- Performance analysis suite
- Rugby clubhouse
- Student Zone
- Rider Performance Centre
- Sports Academy 2



**HARTPURY  
SPORT**



AGRICULTURE | ANIMAL | EQUINE | SPORT | VETERINARY NURSING





## Industry-led research. We want to hear from you!

Our research is focused on improving the animal industry by developing understanding and protocols that enhance animal welfare, performance and interactions. If there is an area in which you wish there was more research we want to hear from you!

Hartpury Animal has the potential to be globally recognised as the destination for animal related education and activities.

Through investment to develop physical resources, University and College students will have outstanding opportunities to enhance their knowledge, demonstrate high standards of animal welfare, gain wider employable skills and make a difference in the real world through research that impacts. The canine industry is rapidly growing and it is an exciting time to develop in areas such as canine performance and HAI that sets Hartpury apart from other providers.

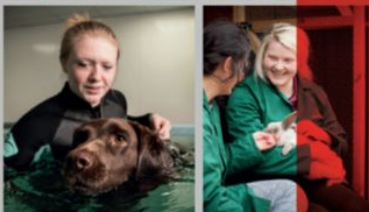

**Contact us:**

Tel: +44 (0) 1452 702 100 Email: [animal@hartpury.ac.uk](mailto:animal@hartpury.ac.uk) [www.hartpury.ac.uk/university/course-areas/animal/](http://www.hartpury.ac.uk/university/course-areas/animal/)

**Hartpury Animal Department:**  
Hartpury University and Hartpury College,  
Hartpury House, Gloucester GL19 3BE





**HARTPURY**



# INNOVATION CAREERS ENTERPRISE



**HARTPURY**  
COLLEGE



**HARTPURY**  
UNIVERSITY

# Enterprise Service

AGRICULTURE | ANIMAL | EQUINE | SPORT | VETERINARY NURSING

Business Centre Space for Students

1:1 Student Business Consultation

Workshops & Speakers

Connection to Start-Up Information

Involvement in Enterprise Projects

Networking with Local Businesses

Yearly Hartpury Enterprise Awards

External Business Events for Students



# The Hartpury talent pool

Sports teaches you character, it teaches you to know what it feels like to win and lose - it teaches you about life.

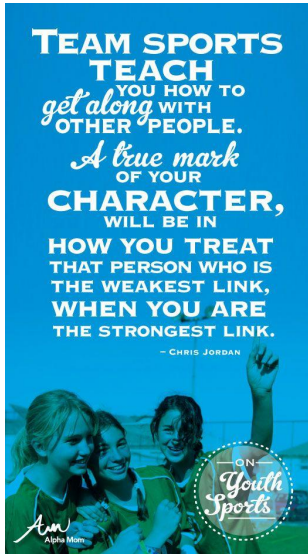

## Showcase, Engage, Impact

Join us to develop your strategic marketing, powerful brand alignment and targeted audience engagement with the potential to reach thousands of spectators, visitors, riders, owners and students.



75  
trade stands

45,000  
followers across  
social media

+400,000  
web page views



### Brand exposure

Enhance your image by aligning your brand with a dynamic sport, world-class Olympic medalists, a healthy lifestyle offer and our aspirational equine audience.

### Customer engagement

Establish relationships and build retention with inclusion in press releases and social media communications to thousands of receptive, affluent town and country consumers.

### Sales opportunities

Launch products, promote services and create experiences with premium retail activity at key events for enthusiastic visitors, competitors and students.

### Industry collaboration

Connect with our research and development opportunities, engaging with Hartpury post-graduates, staff, students and world-leading facilities.

### Community and Social Responsibility

Harness the opportunities afforded by Hartpury's breadth and scale to raise your CSR profile and make a positive impact.

### Employee involvement

Reward, motivate and engage your people by sharing the exhilaration of the equine experience and offering everyone the opportunity to get involved.

### Return on Investment

Work with us to develop a bespoke and comprehensive, high-value three-year strategy for your brand, your stakeholders and your customers.

### Brand impact

Present your vision, your organisational values and mission with a brand story you tell to over three years.

10

## Hartpury Equine in Numbers



800  
therapy and performance  
centre users



10,000  
competitors, 40 countries

Fulfil your commercial goals with a combined sport, education and lifestyle partnership

Hartpury Equine's three-year commercial partnership proposal offers you the chance to harness our international sporting venue, our top-rated education centre and premium lifestyle brand alignment - all within one comprehensive package.

Our three-year package is running from September 2019 to 2022. As an important training hub for Team GB and a major venue for national and international events, Hartpury is preparing for record numbers and equine sport is looking forward to its highest levels of support and profile.

100  
annual events to promote  
your brand

60,000  
visitors and spectators

# Thank you



**HARTPURY**

**Stuart Emmerson, Director of Business Development**

**[Stuart.Emmerson@Hartpury.ac.uk](mailto:Stuart.Emmerson@Hartpury.ac.uk)**

**@stuartemmerson**

A LEVELS, DIPLOMAS, UNDERGRADUATE, POSTGRADUATE, RESEARCH

ANIMAL | AGRICULTURE | EQUINE | SPORT | VETERINARY NURSING



**HARTPURY**  
COLLEGE



**HARTPURY**  
UNIVERSITY



**FOREST**  
ECONOMIC PARTNERSHIP

Delivering a thriving economy

CIC Number: 12262533

# Forest of Dean Recovery



# FoDDC Recovery Action Group Update & Recovery Plan

(Bernie O'Neill & Wendy Jackson)

# Forest of Dean Response & Recovery

## **Covid Business support**

FoDDC business grant payments - £21,690,000

Discretionary grant payments - £1,130,643

## **Ongoing support:**

- Growth Hub SME Recovery & Growth Hub Kick Start Tourism Grants
- FSB Discounted Membership for town centre & village businesses
- Folk2Folk – peer to peer lending
- New business start-up grants



# FoDDC Business Start Up Grants

(Wendy Jackson)

## **A new business start-up grant is being launched on 21<sup>st</sup> September 2020.**

Grant funding can be used towards a variety of business and social enterprise start-up activity including: research and development, installing clean technologies, premises, equipment and product/service launch.

There will be a maximum of £1,000 per application. Allocation will be agreed on projects at an appropriate scale and the ability to proceed to implementation stage.

Applications will be assessed over 3 rounds in 2020/21 with the closing dates for all applications being:

- 23<sup>rd</sup> October 2020
- 18<sup>th</sup> December 2020
- 26<sup>th</sup> February 2021



**Successful applications must deliver three, or more, of the following 6 desired outcomes:**

- New business or social enterprise registrations
- Job creation
- Demonstration of innovation including the design and delivery of new products/equipment/services
- Demonstration of de-carbonisation activity, renewable energy use or the introduction of clean technologies
- Occupation or creation of new commercial floorspace for business use
- Increased footfall / visitor numbers/ visitor spend / turnover for individual business, town or village centre

For more information and to request an application form, please email:

**[Regeneration@fdean.gov.uk](mailto:Regeneration@fdean.gov.uk)**



# Growth Hub Update

(Kevan Spencer)

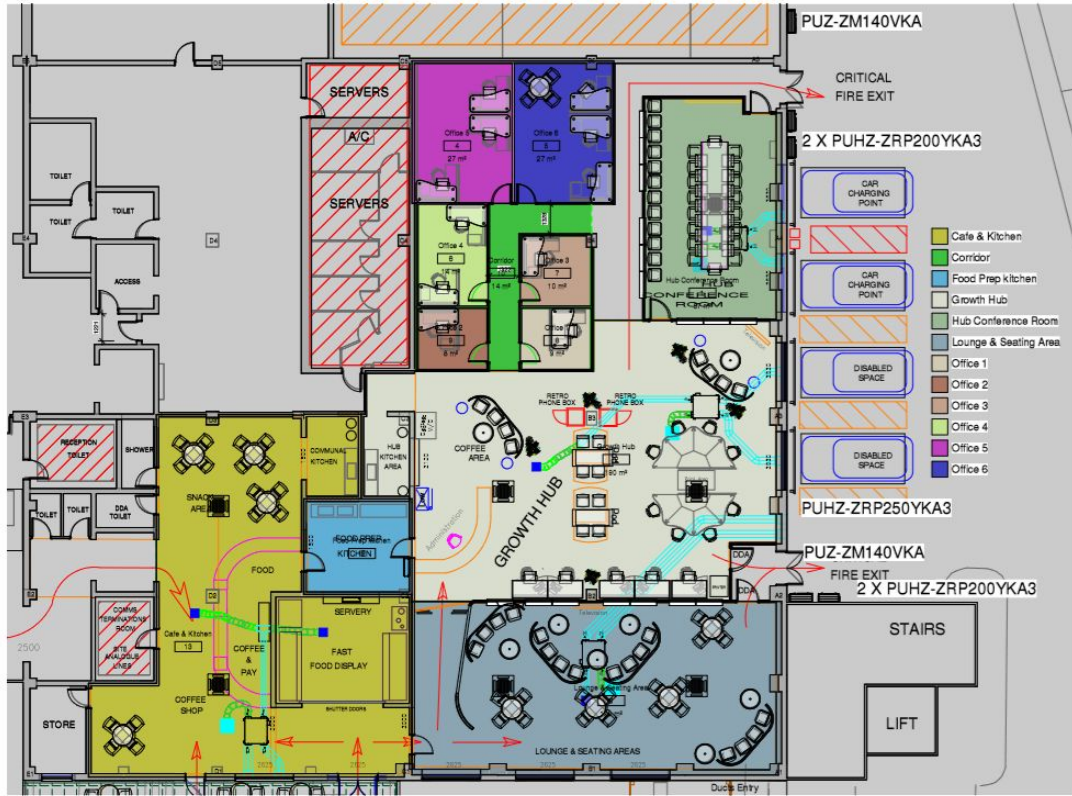

1 - Arch  
1:75





**The first commercially run Growth Hub is set to open by the end of the year:**

- The Growth Hub in Mitcheldean is set for fit out at the end of October beginning of November.
- There are currently two vacancies



# FSB Membership Offer

(Alistair Downham)





**Are you self employed?  
Do you own a small business?  
Are you a Director?**



## Your experts in running a business

At FSB our mission is to help smaller businesses achieve their ambitions. We are the UK's largest grassroots campaigning group promoting and protecting the interests of the self-employed and smaller business owners.

As experts in business, we offer our members a wide range of vital business services<sup>1</sup> including advice, financial expertise, support and a powerful voice heard in governments across the UK.

## Your Benefits



Benefit provided at no extra cost

### FSB Business Banking

Exclusive to FSB members, the FSB Business Current Account provided by The Co-operative Bank, gives you free everyday banking<sup>2</sup> for the duration of your FSB membership.

### FSB Care

Your health and wellbeing is important. If the worst should happen and you become unwell with a serious physical or mental health condition, we offer free access to a Personal Nurse Adviser, an experienced Registered Mental or General Nurse.

### FSB Cash Advance

Access fast, flexible funding with no hidden repayment fees. Get funding tailored for your business and matched to your cash flow needs.



### FSB Cyber Protection

Providing you with access to both an advice line and a limited insurance designed to support and protect your business at no extra cost.

### FSB Debt Recovery

Our FSB Debt Recovery service will assist you in recovering money owed to your business.

### FSB Employment Protection

Our employment law advice service is here to make your life easier with important information and guidance on employment legislation in the UK. As a member you have access to round-the-clock legal advice on all employment issues, as well as insurance protection in the event you are taken to an employment tribunal.

### FSB Funding Platform

Helping FSB members find the right business finance solution. You make one simple application and with 24/7 telephone support the service is simple and easy to use, saving you time and effort.

### FSB Health and Safety Advice

Members have access to the latest information on health and safety in the workplace, written and regularly updated by industry experts. You will be able to talk to industry experts and benefit from the latest online training modules in key areas of health and safety.

### FSB Insurance Service

FSB Insurance Service is a fully fledged general insurance broker, able to work with you to source the right insurance products for your business, along with a wealth of services and assets, foremost of which is the insurance advice line.

### FSB Legal Hub

Our one-stop-shop has over 430 factsheets and in excess of 750 legal documents to choose from, covering the key legal, HR, tax and health and safety issues that you might encounter when setting up and running your business.

### FSB Legal Protection Scheme

Our Legal Protection Scheme gives you and your business access to a wide range of legal and tax support – be it through our advice lines, our online Legal Hub or our insurance protection.

### FSB Payments

FSB Payments is key to helping your business grow, with a simple, efficient and seamless payments experience to suit your business needs. FSB Payments can help you to unlock new ways to grow and we have the expertise and experience to help support businesses in the ever-changing payments world.

### FSB PR/Crisis Management Helpline

Our PR/Crisis Management advice service is here to make your life easier with important information and guidance from a public relations expert who can assist you in handling a crisis.

### FSB Tax Investigation Protection

Members have automatic access to comprehensive and free tax advice and tax investigation insurance – protecting you if you're selected for certain business related HMRC investigations.

### FSB Workplace Pensions

A straightforward and cost-effective solution specifically designed to help small businesses ensure their workplace pension scheme is fully compliant. It is also easy to add on a bespoke and fully supported payroll service.

## SUBSCRIPTIONS

NUMBER OF EMPLOYEES	0	1-4	5-10	11-20	21-30	31-40	41-50	51-100	101-150	151+
ANNUAL SUBSCRIPTION	£147	£199	£253	£304	£371	£402	£449	£577	£980	£980*
REGISTRATION FEE**	£30	£30	£30	£30	£30	£30	£30	£30	£30	£30
TOTAL	£177	£229	£283	£334	£401	£432	£479	£607	£1010	£1010+

Associate £65 per annum plus registration fee. \*\*Plus £5 per employee over 150. \*\*\*Registration fee only payable in the first year of membership.

1. All services are provided to members as subject to terms and conditions.  
2. Subject to acceptance, terms and conditions apply.

## CONTACT US

Telephone 0800 20 20 888  
Email [customerservices@fsb.org.uk](mailto:customerservices@fsb.org.uk)  
Online [fsb.org.uk/join](https://fsb.org.uk/join)



Search for Federation of Small Businesses



**FSB and FoDDC are offering a discount scheme to businesses within the following areas:**

- Cinderford
- Coleford
- Newent
- Lydney
- Mitcheldean
- Drybrook
- Newnham
- Bream
- Tutshill & Sedbury



**FOREST**  
ECONOMIC PARTNERSHIP

Delivering a thriving economy

CIC Number: 12262533

# Electing a New Chair

(Andrew Callard)



**FOREST**  
ECONOMIC PARTNERSHIP

Delivering a thriving economy

CIC Number: 12262533

**AOB**

**(Andrew Callard)**



**FOREST**  
ECONOMIC PARTNERSHIP

Delivering a thriving economy

CIC Number: 12262533

# Next Meeting:

**17 December 2020**

**9:30 to 11:30**